

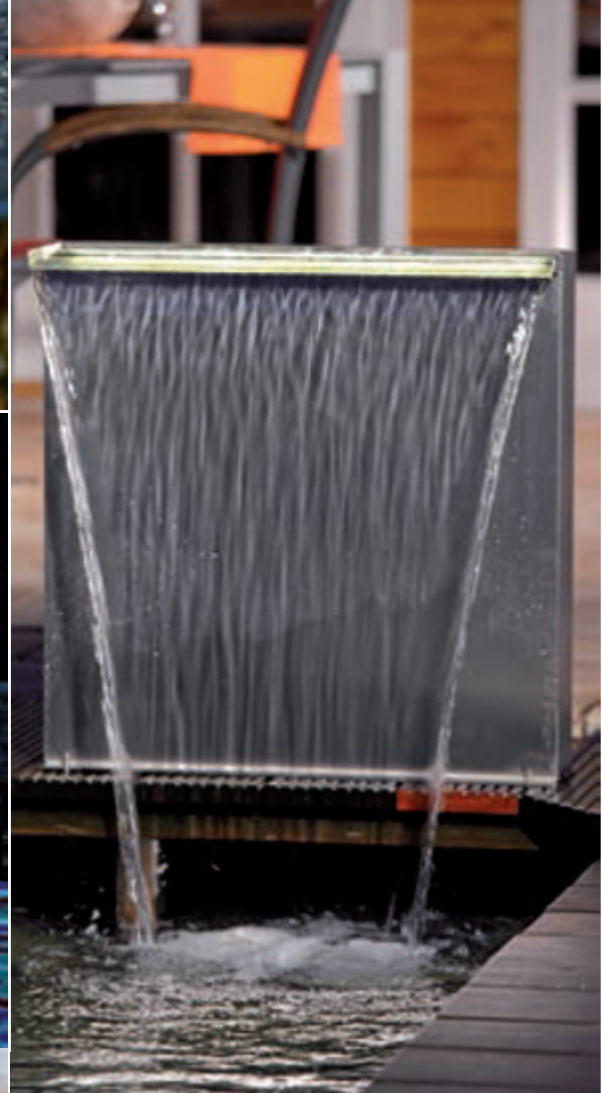

The waterfall illumination emphasises the contours of the water pattern and ensures atmospheric lighting



WATERFALL ILLUMINATION

*LED waterfall lighting –
for stylish light accents in the evening*

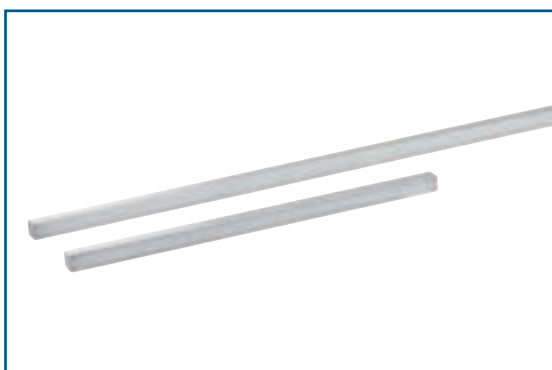

- LED lighting for waterfalls, for terrace pond edge decoration, in widths 30 and 60 cm
- Suitable for use underwater and above the water
- Suitable for permanent underwater use, thanks to protection class IP68 (connection IP 44)
- Easy to retrofit, thanks to innovative plastic carriage
- Uniform light pattern thanks to virtually invisible LEDs
- Pleasant warm-white light colour
- High-quality, stainless steel enclosure

PRODUCT DETAILS



Plastic carriage

The innovative plastic carriage in discrete grey enables easy retrofit of the waterfall lighting at any time.

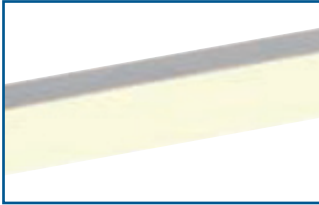

LED technology

The warm-white LEDs ensure pleasing light and at the same time they are extremely durable and energy-efficient



Attractive water pattern

The light rail is placed at an optimal height in the waterfall and consequently supports the harmonious water pattern.

Extras

Top product characteristics

- Easy to retrofit waterfall lighting system
- Pleasant warm-white light colour
- It is also ideal for terrace or pond edge lighting

Recommendation

Combine Waterfall Illumination light rails with Waterfall 30 and 60 or with the stands, Waterfall Set 30 or Waterfall Set 60 Solo. Set focussed accents at the edge of the pond or on the terrace, as well as between cobblestones or for framing a wooden terrace.

Recommended supplemental products

Waterfall 30
Item no. 50704
(page 290)

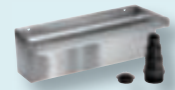

Waterfall 60
Item no. 50585
(page 290)

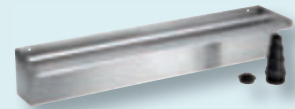

Waterfall Set 30
Item no. 50584
(page 291)



Waterfall Set 60 Solo
Item no. 51163
(page 291)



Set focussed accents at the edge of the pond or on the terrace, as well as between cobblestones, or for framing a wooden terrace.

TECHNICAL DATAS

		Waterfall Illumination 30	Waterfall Illumination 60
Dimensions (L x W x H)	mm	300 x 15 x 15	600 x 15 x 15
Rated voltage (primary, secondary)		220 - 240 V / 50/60 Hz, 12 V / DC	
Power consumption	W	5	10
Energy efficiency class - light fixture ¹⁾		B	
Protection class		IP 68, IP 44 (power unit)	
Power cable length	m	10.00	
Net weight	kg	1.12	1.28
Guarantee *P. 310	Years	2	
Illuminant type		LED	
Light flux	lm	90	180
Light colour		neutral white	
Colour temperature	K	3500	
Item no. (GB-Version)		-	
Item no.		51205	51209

¹⁾page 310



¹⁾ Additional instructions concerning the energy efficiency classes are provided on 302