



	Fresh Water	Pool Water	Sea Water	220-240 V	400 V	110-120 V	50 Hz	60 Hz	12 V AC	24 V DC	DMX	DMX/RDM	Plug and Spray
ProfiLux E 101 Halogen													
LunAqua 10 Halogen													

PROFILUX E 101 AND LUNAQUA 10 HALOGEN

Thanks to the compact design the ProfiLux E 101 to accentuate public areas with focused light effects and allow sculptures, water features, individual fountains, or plants, to radiate in light.

The housing of the halogen spotlight is made of robust stainless steel and is fitted with a PG 13.5 cable gland, as well as with a pivoting spotlight holder – also made of stainless steel.

Product characteristics at a glance

- High-quality stainless steel spotlights
- Stainless steel bracket for simple and safe installation
- Halogen bulbs: 50 W, 75 W and 100 W
- With PG 13.5 cable entry

The spotlight, made of impact-resistant plastic, is connected to the 12-Volt safety transformer via special connections that can also be used underwater. This means that even greater distances to the 230 Volt outlet can be bridged with conventional cable. The transformer is equipped with 4 couplings to connect either 4 x 35 W, 3 x 50 W or 2 x 75 W, 12 V. The special structured glass cover, in conjunction with the aluminium reflector, creates optimal light efficiency. The mounting bracket enables a pivot range of approximately 180°.

Product characteristics at a glance

- Accentuates with rich light effects
- Can be implemented underwater and above the water surface (excl. 75 W lamp)
- Housing made of impact-resistant plastic
- Structured special glass cover for optimal light efficiency
- Mounting bracket with 180° pivot range



ProfiLux E 101



LunAqua 10

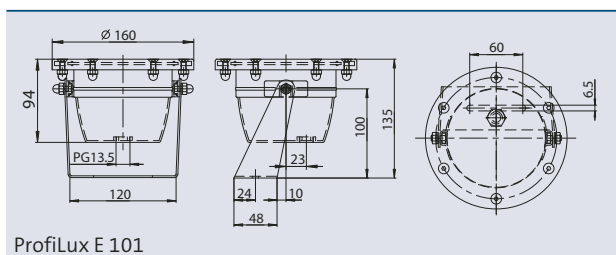

ProfiLux E 101

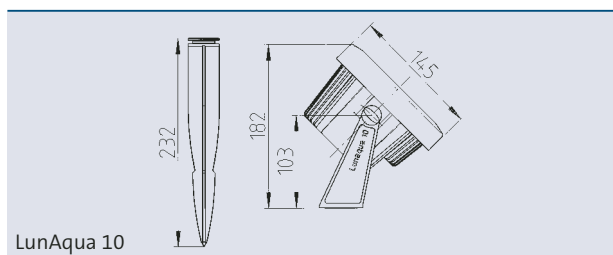

LunAqua 10

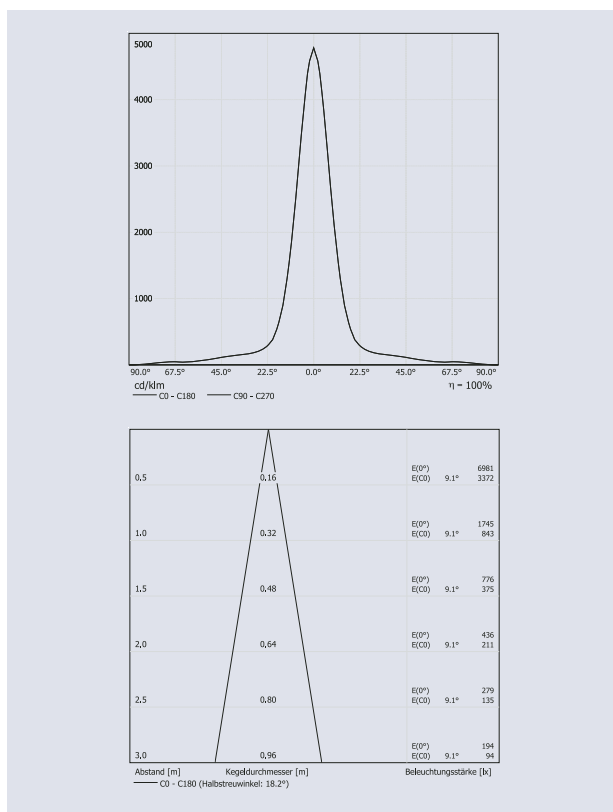
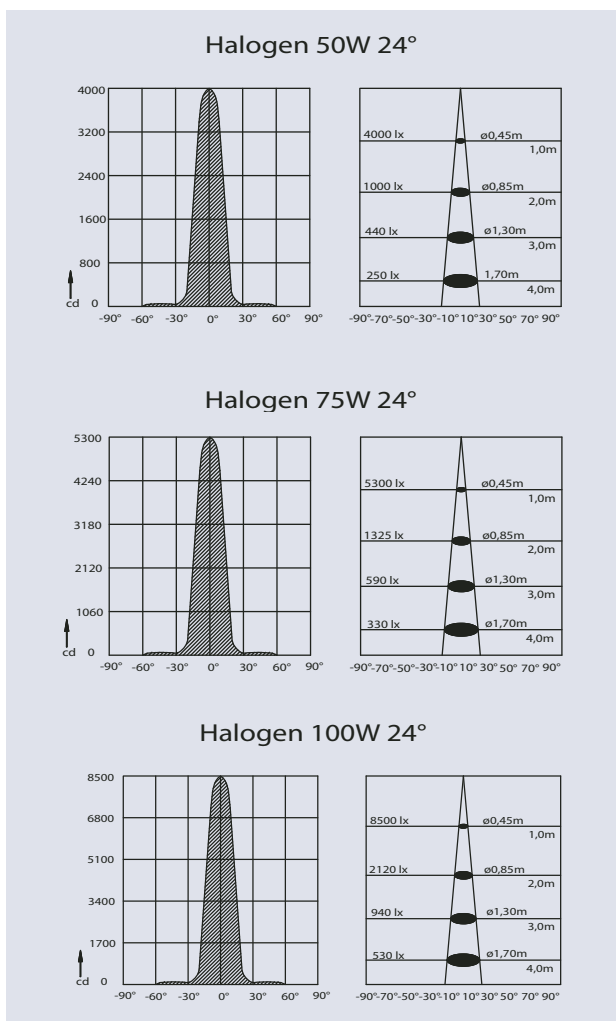

Accessories for LunAqua 10 (must be ordered separately)

Bulbs halogen bulb			
Colour	white	white	white
Voltage [V/Hz]	12/50-60	12/50-60	12/50-60
Power output [W]	35	50	75
Order no.	54035	54036	54037

Accessories (must be ordered separately)

Underwater transformer UST 150/01 (see page 190)	50401
Underwater transformer UST 150/A/01 (see page 190)	50517
Connecting cable 12V AC/01 (see page 160)	Order no.
Cable 12V AC /3.0 m/01	12374
Cable 12V AC /7.5 m/01	12375
Cable 12V AC /15.0 m/01	11740
Power Box	Order no.
Power Box 12V AC/01 (see page 160)	50492

Spotlight LunAqua 10 halogen Delivered without bulb, transformer and cable	
Dimensions in mm (Ø x H)	[mm] 145 x 100
Nominal voltage	[V/Hz] 12/50-60
Bulb max.	[W halogen] 35 – 75 W halogen
Beam angle	[°] 24
Protection class	IP 68
Weight	[kg] 1.1
Order no.	54034

Accessories for ProfiLux E 101 (must be ordered separately)

Halogen reflector bulb			
Voltage [V/Hz]	12/50-60	12/50-60	12/50-60
Power output [W]	50	75	100
Beam angle	24°	24°	24°
Order no.	52939	52941	52943

ProfiLux E 101 Delivered without bulb, transformer and cable	
Dimensions (Ø x H)	[mm] 160 x 135
Beam angle	[°] 24
Light intensity	[cd] 4000-5000
Bulb	[V/Hz] 12/50-60
Power consumption max.[W halogen]	50, 75 W halogen
Protection class	IP 68
Cable entries	1x PG 13.5
Material	Stainless steel 1.4301 (AISI 304)
Weight	[kg] 1.5
Order no.	56133

*bulbs excluded from the guarantee

Please consider the informations given in the manual if you wish to connect existing and new LunAqua 10 products!